

Imagine Villa

Spring Estate - Bequia
St. Vincent & the Grenadines

0.46 Acres

\$950,000 US

Exceptional contemporary villa located in an ideal elevated location in Spring Estate. Spring Bay views, two double bedrooms and two self contained studios.

- High Quality, Low Maintenance
- Infinity Swimming Pool
- Excellent Rental Property



Imagine Villa

Sleeping up to 8, this spacious villa has been designed to entertain on a grand scale. Inspired by the modernist movement of Bauhaus this brilliantly structured and executed property has been created from clean, minimal lines and presents an uncluttered interior. Maintaining the minimalist ethos this house offers a clean edifice that is beautiful in its simplicity; the sharp bleached angles of the villas facade set against the turquoise sky are in themselves a piece of art and much admired upon the island.

Imagine Villa has been designed, built and beautifully maintained with recent additional features including the refurbishment of the guest apartment with new fixtures, fittings and furnishings throughout, all the villas bedrooms have new beds and the pergola by the pool has been improved and offers greater protection from the sun via adjustable louvres and a new roof. The bathroom is greater improved by the addition of an electric ventilation system.

Infinity and Beyond

The curved infinity pool set in front of the property has elevated views over Spring Bay and Bequias' lush tropical vegetation. Built into the pool is an "endless" treadmill / massage feature and set to the side sits a pristine modernist gazebo, bleached white as the rest of the property and offering respite from the Caribbean sun. The gazebo features a fixed stone table and lounging area.

The exterior of the property is finished in a crisp white render with the glass of the villas windows coated in a Bequianian blue anti UV screen which is also reflected in the design of the pool and outdoor furniture. Stone blue planters feature architectural plants which provide a good contrast with the clean white lines and angles. The bedrooms on the upper level have balcony's above the pool area which are framed by sleek, steel handrails. The wide glass doors from the gazebo and pool area opening into the kitchen and living space encourage a natural social flow whilst entertaining guests.



Imagine Life on Bequia

Minutes from the town of Port Elizabeth and close to Spring Bay, Princess Margaret, Lower Bay and Friendship Bay Beaches this villa is both secluded and conveniently placed for all the islands amenities. Spring Bay Beach is very quiet and only minutes away, Princess Margaret at Belmont is one of the best and most popular beaches on the island and Lower bay is particularly good for swimming, kayaking and snorkeling. The district of Spring is composed of a quiet international community of independent hillside villas. An area of secluded lush tropical foliage fringed by mature palms running down to a coral sandy beach Spring is ideally placed for privacy and convenience.

Crisp, Cool Kitchen Lines

Clean and white this kitchen has a stainless steel gas range cooker, an elegant workspace / counter stretching across the length of the room, fitted storage cupboards, a double sink, dishwasher, vintage style ceiling fan and superb island views. A counter at the kitchens larger of the louvred windows offers access to refreshments from the outside with several high stools positioned outside for convenience. High backed chairs leading off a glossy counter, lit by a series of hanging steel pendant lamps generate the feel of a relaxed coffee house and an ideal place for friends and family to gather during the meal preparation.

Imagine Amenities

The kitchen easily accessed from the pool area also has a well equipped laundry room close by. The double bedrooms are both en-suite. The large walk in shower tiled in the same Bequianian blue, a theme which runs throughout the property, shares the same uncluttered clean lines and is cooled by the high white louvred windows. The bedrooms feature a selection of modern artwork, fitted wardrobes with white wooden louvred doors and are generally cool and uncluttered in style. The cooling tradewinds carry natural soothing aromas of the islands indigenous flora and fauna such as coconut, white cedar and bougainvillea through the upper and lower floors.

Relax and Party

Large windows and doors, high ceilings, a hillside position and air conditioning work together to provide an atmosphere of refreshing serenity inside Imagine. The comfortable interior temperature is also helped by the blue coating on the inside of the glass, which cannot be seen from the interior but does reduce the UV rays and the impact of the sun. The main open living room has a collection of recessed areas in the wall which present original modern pieces without compromising the light and space. Large sofas offer room for guests to relax in close proximity to the kitchen and dining room. The overall layout, exterior dining facilities, well equipped kitchen and bedroom arrangements contribute to the fact that this villa is an extremely popular rental property.

GRENADINE ISLAND VILLAS
thegrenadines@mac.com
+44 (0) 800 04814

Highlighted Plot - Imagine Villa
Spring Estate, Bequia
St. Vincent & the Grenadines

Scale 1:2500



GRENADINE ISLAND VILLAS

web: www.grenadinevillas.com

email: thegrenadines@mac.com

+1 (784) 529 8046

+1 (784) 457 3739

+44 (0) 800 048 4814



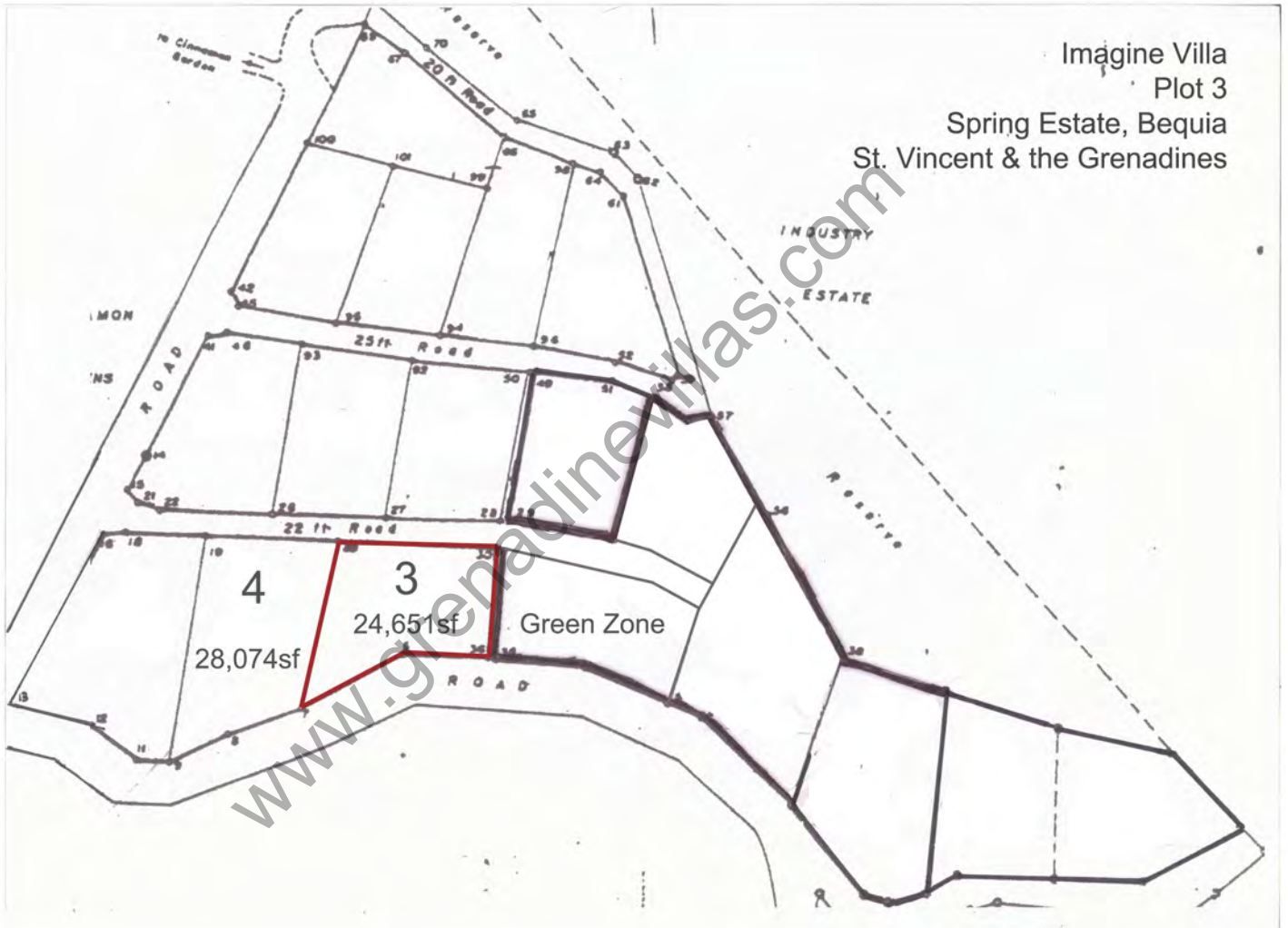

DESIGN & CONCEPTS SVG LTD. - VILLA PROJECT 2006

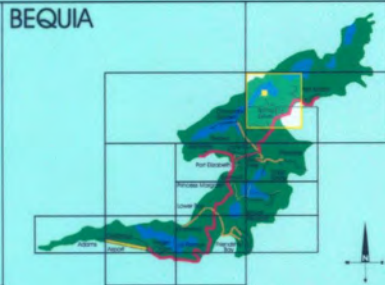

PROJECT: HOUSE ROLAND & ALISON
SPRING ESTATE
BEQUIA - WEST INDIES

ARCHITECT: DESIGN & CONCEPTS SVG LTD.
PORT ELIZABETH - P.O. BOX 145
BEQUIA - WEST INDIES
TEL 1 (784) 457 3500
EMAIL design&concepts@caribsurf.com

BUILDING QUALITY HOMES

CONTRACTOR: LAUN LESLIE
P.O. BOX 141 BQ
BEQUIA - WEST INDIES
TEL / FAX 1 (784) 457 3472
MOBILE 1 (784) 526 2418
EMAIL launleslie@yahoo.com



SITEPLAN



FIRST FLOOR



GROUND FLOOR

www.grenadinevillas.com



VIEWPLAN EAST



VIEWPLAN SOUTH



VIEWPLAN NORTH





SITEPLAN

SCALE 1 : 200
SPRING ESTATE - BEQUIA - W.I.
LOT 3 - 24,651 S.F.
DESIGN BY ROLAND MINDER
DATE MAY 2005

GRENADINE ISLAND VILLAS

web: www.grenadinevillas.com

email: thegrenadines@mac.com

+1 (784) 529 8046
+1 (784) 457 3739
+44 (0) 800 048 4814



HOUSE ROLAND & ALISON

www.grenadinevillas.com



www.grenadinevillas.com

VIEWPLAN SOUTH

SCALE 1/8" = 1'0"
SPRING ESTATE- BEQUIA - W.I.
LOT 3 - 24,651 S.F.
DESIGN BY ROLAND MINDER
DATE MAY 2005

COPYRIGHT 2005
DESIGN & CONCEPTS SVG LTD.

GRENADINE ISLAND VILLAS

web: www.grenadinevillas.com

email: thegrenadines@mac.com

+1 (784) 529 8046
+1 (784) 457 3739
+44 (0) 800 048 4814



HOUSE ROLAND & ALISON

www.grenadinevillas.com



www.grenadinevillas.com

VIEWPLAN EAST

SCALE 1/8" = 1'0"
SPRING ESTATE- BEQUIA - W.I.
LOT 3 - 24,651 S.F.
DESIGN BY ROLAND MINDER
DATE MAY 2005

COPYRIGHT 2005 DESIGN & CONCEPTS SVG LTD.

GRENADINE ISLAND VILLAS

web: www.grenadinevillas.com

email: thegrenadines@mac.com

+1 (784) 529 8046
+1 (784) 457 3739
+44 (0) 800 048 4814





GRENADINE ISLAND VILLAS

web: www.grenadinevillas.com

email: thegrenadines@mac.com

+1 (784) 529 8046

+1 (784) 457 3739

+44 (0) 800 048 4814





FIRST FLOOR

SCALE 1/8" = 1'0"
SPRING ESTATE - BEQUIA - W.I.
LOT 3 - 24,651 S.F.
DESIGN BY ROLAND MINDER
DATE MAY 2005

COPYRIGHT 2005 DESIGN & CONCEPTS S/VG LTD.

GRENADINE ISLAND VILLAS

web: www.grenadinevillas.com

email: thegrenadines@mac.com

+1 (784) 529 8046
+1 (784) 457 3739
+44 (0) 800 048 4814





BASEMENT

SCALE 1/8" = 1'0"
SPRING ESTATE - BEQUIA - W.I.
LOT 3 - 24,651 S.F.
DESIGN BY ROLAND MINDER
DATE MAY 2005

COPYRIGHT 2005 DESIGN & CONCEPTS SVG LTD.

GRENADINE ISLAND VILLAS

web: www.grenadinevillas.com

email: thegrenadines@mac.com

+1 (784) 529 8046

+1 (784) 457 3739

+44 (0) 800 048 4814





GRENADINE ISLAND VILLAS

web: www.grenadinevillas.com

email: thegrenadines@mac.com

+1 (784) 529 8046

+1 (784) 457 3739

+44 (0) 800 048 4814





GRENADINE ISLAND VILLAS

web: www.grenadinevillas.com

email: thegrenadines@mac.com

+1 (784) 529 8046
+1 (784) 457 3739
+44 (0) 800 048 4814





GRENADINE ISLAND VILLAS

web: www.grenadinevillas.com

email: thegrenadines@mac.com

+1 (784) 529 8046

+1 (784) 457 3739

+44 (0) 800 048 4814





GRENADINE ISLAND VILLAS

web: www.grenadinevillas.com

email: thegrenadines@mac.com

+1 (784) 529 8046

+1 (784) 457 3739

+44 (0) 800 048 4814

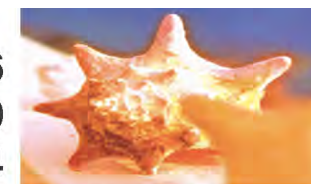



GRENADINE ISLAND VILLAS

web: www.grenadinevillas.com

email: thegrenadines@mac.com

+1 (784) 529 8046

+1 (784) 457 3739

+44 (0) 800 048 4814





GRENADINE ISLAND VILLAS

web: www.grenadinevillas.com

email: thegrenadines@mac.com

+1 (784) 529 8046
+1 (784) 457 3739
+44 (0) 800 048 4814

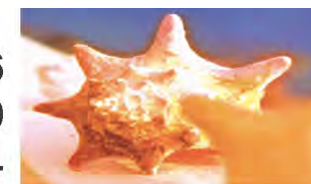



GRENADINE ISLAND VILLAS

web: www.grenadinevillas.com

email: thegrenadines@mac.com

+1 (784) 529 8046
+1 (784) 457 3739
+44 (0) 800 048 4814





GRENADINE ISLAND VILLAS

web: www.grenadinevillas.com

email: thegrenadines@mac.com

+1 (784) 529 8046
+1 (784) 457 3739
+44 (0) 800 048 4814

